

Thank you to our Convention Sponsor:

Tuesday, July 17, 2018

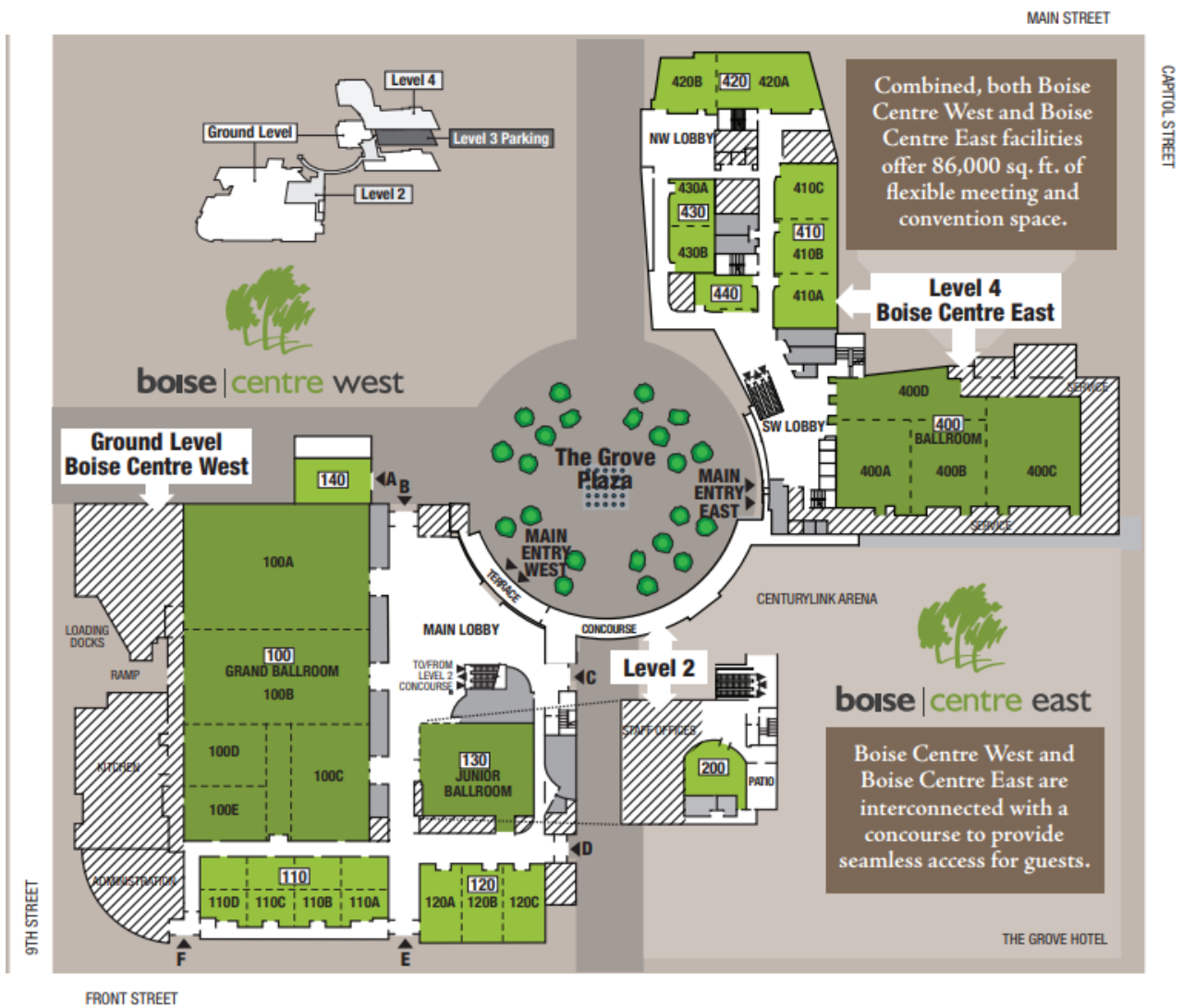

2018 IHCA Convention & Tradeshow  
 “Hearts that Care, Hands that Serve”  
 July 17 – 19, 2018  
 Boise Centre



7:00am	<b>CHECK-IN / Registration OPENS</b>							
	Hospitality Beverages sponsored by: <b>Advanced Lifeline Respiratory Services</b>							
8am-9:45am	Opening Ceremony: American Legion Post 113 Meridian Welcome: <b>Mark Maxfield, IHCA Board President</b> <b>Mark Parkinson, President &amp; CEO, AHCA-NCAL</b> Showing Up with Your Whole Self... Leading from Your Heart Keynote Speaker: <b>Craig Zablocki</b> Room 100 CDE						Dietary Manager Students ONLY (8 am – 5 pm)	
1.0 CEUs	Room	100 CDE	120	130	140			
10:00am-11:30am	Lighten Up and Laugh – For the Health of It	The Square and The Triangle		DC Update			Dietary Manager Students ONLY (8 am – 5 pm)	
1.5 CEUs	<b>Craig Zablocki</b>	<b>Mark Stevens</b>		<b>Mark Parkinson AHCA</b>				
11:30am-12:30pm	<b>VIP TRADESHOW</b> Food & Beverages sponsored by: Decision-makers by invitation – only (must have sticker on your name badge) Room 100 AB							
12:30pm - 1:30pm	<b>GENERAL TRADESHOW</b> OPEN TO ALL REGISTERED ATTENDEES with Drawings for CASH prizes donated by: MUST be present to win!							
	Room	100 CDE	110 CD	110 AB	120	130	400 A Boise EAST	140
1:45pm-3:15pm	WE is Greater than I Plus You!	The Nature of Things: Sexuality in Long Term Care - Considerations and Care Planning	Managing Your Survey	Effective Programming: A Hidden Secret to Higher Occupancy	Reducing Inappropriate Use of Antipsychotics in Long-Term Care Populations	The Fun Theory: Transforming Dementia Care through Person-based Technology	Dietary Manager Students ONLY (8 am – 5 pm)	
1.5 CEUs	<b>Craig Zablocki</b>	<b>Carin Marney</b> <b>Dr. Banta</b> <b>Natalie Nathan</b>	<b>David Scott</b>	<b>Nina Sanderson</b>	<b>Eric Collett</b>	<b>Dr Abhilash Desai</b> <b>Dr Adam Kipp</b>	<b>Jack York</b>	
3:30pm-5:00pm	X	Healthcare Fraud & Prevention	Opioid Dependence, Fall Risks, & Drug Diversion	Caring From The Heart	What the Administrator Needs to Know About the New Proposed PDPM	The Lost Art of Storytelling		
1.5 CEUs		<b>Harold Malkin</b>	<b>Shawn White</b> <b>Lyman Holyoak</b>	<b>Joyce Marlar</b>	<b>Robin Hillier</b>	<b>Rich Cartney</b>		
5pm – 6:30pm	<b>“Happy Hour Social”</b> by invitation-only Music by: <b>Patrick Rice</b> Room 100 CDE - Sponsored by: <b>Molina Healthcare</b>							

IHCA Platinum Partners:

### Wednesday, July 18, 2018

Thank you to our Convention Sponsor:

### Thursday, July 19, 2018

CHECK-IN / Registration OPENS							
7:00am	Hospitality Beverages sponsored by: The Meadow						
	<b>100 B</b>	<b>100 C</b>	<b>100 DE</b>	<b>110 AB</b>	<b>110 CD</b>	<b>120</b>	<b>130</b>
<b>8:30am-10:00am</b> 1.5 CEUs	QAPI - A Team Approach  <b>Maryruth Butler</b>  <b>Mindy Shepard</b>	Nutrition-Focused Physical Examination for Adults Part 1: An Approach to Build Skills  <b>Terese Scollard</b> <b>(Abbott Nutrition)</b>	Cognitive Therapy vs Psych Therapy for Dementia  <b>Danielle Wallner</b>  <b>Steve Peterson</b>	Working with Law Enforcement  <b>Danielle Young</b>  <b>Penelope Hansen</b>	Engaging Residents & Families: Hearing the Voice & Offering the Choice  <b>Margie Zamzow</b>	Person-Centered Care Planning Under the Revised RoPs  <b>Robin Hillier</b>	Activities for Mixed Populations  <b>Sherri Ellis</b> <b>April Floyd</b> <b>Ellen Burnell</b> <b>TJ Wilson</b>
<b>10:15am-11:45am</b> 1.5 CEUs	Is it a Marriage Made in Heaven? Enhancing The Administrator & DNS Relationship  <b>Eric Collett</b>	Part 2: Grip Strength in Patient Functional Assessment  <b>Terese Scollard</b> <b>(Abbott Nutrition)</b>	Medicaid Reimbursement - Making the Most Out of the UAI  <b>CANCELLED</b>	Assistive Technology: Life Tools and Caregiver Tools  <b>Krista Kramer</b> <b>Nicholas Stallings</b>	Who Do You Listen to When Mom Might Not Have Capacity? Advanced Directives, POST, Guardianship  <b>David Wilson</b>	MDS Roundtable Discussion  <b>Robin Hillier</b>	Utilizing Technology in Activities  <b>Oni Kinberg</b> <b>April Floyd</b>
<b>11:45am-1:30pm</b>	<b>IHCA General Membership Meeting &amp; Lunch (IHCA Members Only)</b> <b>Room 100 A</b>						
<b>1:45pm-3:15pm</b> 1.5 CEUs	Quality Measures and the UPL Payments-Upcoming Changes  <b>Rick Holloway</b> <b>Alex Childers-Scott</b>	International Dysphasia Diet Standardization Initiative (IDDSI) It's Easier to Swallow!  <b>Sean Curran &amp; Anne Leaf</b>	Making a Business Case for a Healthy AL Facility  <b>Allen Rathey</b>	Record Low Unemployment Numbers?! Health Care Recruiting in This Economic Climate  <b>Blake Thiess</b>	What Would You Do If You Had Limited Time.....  <b>Honey Goodman</b>	Common MDS Coding Mistakes  <b>Robin Hillier</b>	Behavior Plans & Monitors  <b>Lea Stoltz</b>
<b>3:30pm-5:00pm</b> 1.5 CEUs	Idaho Medicaid Dual Eligible Programs  <b>Chris Barrott</b> <b>Jenny Robertson</b> <b>Rachelle Lopez</b>	IDDSI - It's Easier to Swallow! (Part 2)  <b>Sean Curran &amp; Anne Leaf</b>	Accreditation vs. Survey for ALs Panel ***** ICF Provider Meeting <b>Room 140</b>	Working with Guardians & Conservators & Care Managers  <b>Dee Childers</b> <b>Paul Seideman</b> <b>Julie Robinson</b>	Ethics in LTC...What Do You Do When a Resident Reminds You of Your Mother?  <b>Oni Kinberg</b>	MDS, CAAs, & Care Planning for Activity Directors  <b>Robin Hillier</b>	Seniors Got Talent - Hee Haw by Spring Creek Ustick  <b>Diana Cullin</b> <b>Lynda Huddleston</b>

CHECK-IN / Registration OPENS					
7:00am	Hospitality Beverages sponsored by: The Meadow				
	<b>100 B</b>	<b>100 C</b>	<b>100 DE</b>	<b>110 AB</b>	<b>140</b>
<b>8:30am-10:00am</b> 1.5 CEUs	The 7 KEYS To Personal Success and Happiness in a Healthcare Job  <b>Clint Maun</b>	Idaho Caregiver Grant Project for SNFs  <b>Robert Vande Merwe</b> <b>Monica Perry</b>	The Current State of Healthcare Emergency Management  <b>Nate Elkins &amp; Katy Dudley</b>	Avoiding Discrimination and Harassment Claims in the Wake of #MeToo  <b>Pam Howland</b>	<b>Dietary Manager Students ONLY (8 am - 3 pm)</b>
<b>10:15am-11:45am</b> 1.5 CEUs	Advancing Superior Staff Retention  <b>Clint Maun</b>	Medicaid Program Integrity Unit Audits and Provider Self Reports  <b>Lori Stiles</b>	The Basics of Exercise Design: How to Create Your Own Tabletop Exercise  <b>Nate Elkins &amp; Katy Dudley</b>	Comprehensive Functional Assessments, Functional Behavior Assessments and Behavior Implementation Plans  <b>Jason Carlson</b>	
<b>11:45am-1:30pm</b>	<b>IHCA AWARDS Lunch MC - Clint Maun (Ticket Purchase Required)</b> <b>Room 100 A</b>				
<b>1:45pm-3:15pm</b> 1.5 CEUs	New SNF Survey Process - What's the Data Show?  <b>Debby Ransom</b>	Top 10 Citations & How to Avoid Them  <b>H &amp; W - AL</b>	Solutions to Challenges in the Built Environment: Water Quality Management, Mold, Radon, Asbestos, and Other Indoor Hazards  <b>Ben Stutzman</b> <b>Jeff Parsons</b>	Employee Benefits/Wage Survey & the Costs of Turnover  <b>Jeff Colby</b> <b>Michael Reph</b> <b>Kristy Clark</b>	<b>Dietary Manager Students ONLY (8 am - 3 pm)</b>
<b>3:15 pm</b>	<b>"Bid for Baskets" Raffle Foundation prizes announced... MUST be present to win! Foundation Corner in The Meadow</b>				

**MOBILE APP USER TIPS**

- **Start** by going to <http://conventionready.com/idhca-2018/> and selecting "Jul 17"
- **Log in** using your email address and the password you received by email. Check your "Spam" folder.
- **Don't have your password?** Just click "Forgot Password" . . . or select "Sign Up" and enter sign-up code "idhca2018".  
Add our Mobile App to your device's home screen:
  - For Apple: "Open in Safari". Tap the Share icon and choose "Add to Home Screen"
  - For Android: Press the Menu icon in the upper right of the browser and choose "Add to home screen," then tap Add.

IHCA Platinum Partners:

